



iNERGY

# HOUSEHOLD MACERATING PUMP

**FL0700-AK**

**FL0700-BK**



22, FLO700-AK&BK Specifications:

Specification	USA	EUR
Max vertical lift	36 FT	11 M
Max horizontal lift	360 FT	110 M
Rated flow	2400 GPH	9000 L/H
Input power	9/10HP	700W
Voltage	110-120V	220-240V
Frequency	60HZ	50HZ
Protection class	IPX4	IPX4

3. Installation (diagram)

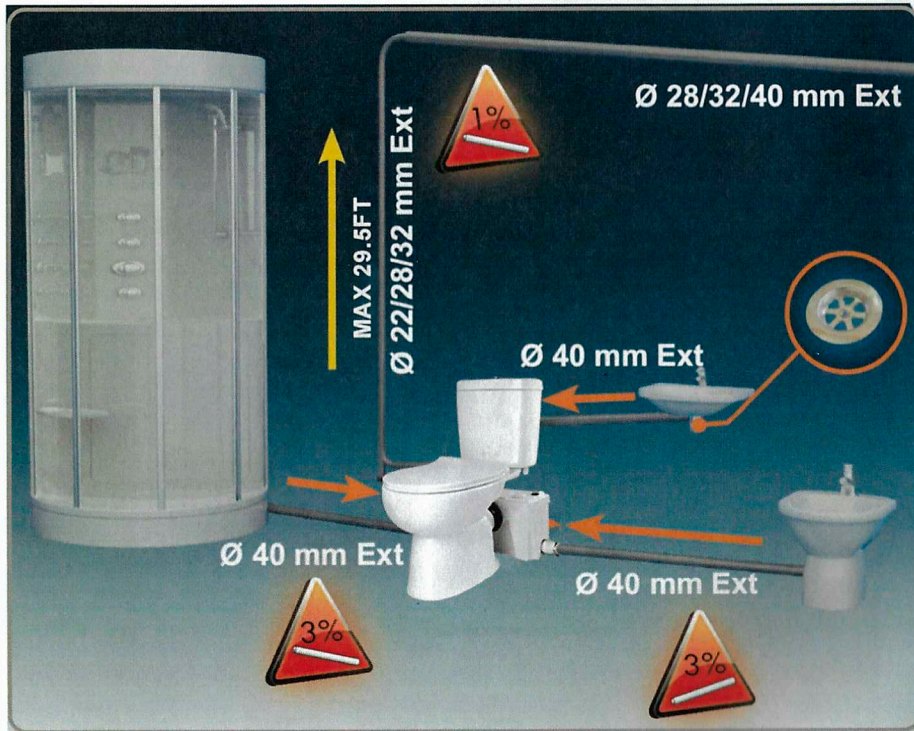

4, Accessory List

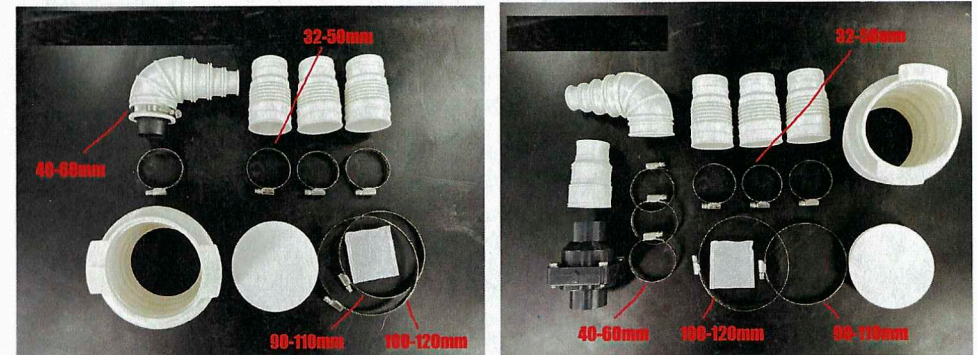

FLO700-AK

FLO700-BK

5, INSTALLATION INSTRUCTIONS.

(5-1), Install the rubber sleeve (D) onto the sewage pump and lock it with a 90-110mm hose clamp (G). Be careful not to install the rubber backwards.

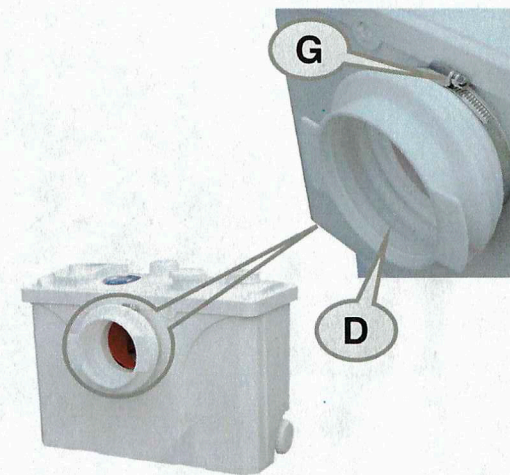

(5-2), The customer can select the accessory **A-B** and check that the hose clamp of the accessory is locked before installation. Then the customer choose the size of the drain pipe, which is available in 1" (28mm), 1-1/4" (32mm) or 40mm(1-1/4" )sizes. The dimensions are marked on the accessories and the customer is free to choose. In this installation example we choose the 1-1/4" (32mm) drain pipe size. Then use a knife to cut the extra.

**Note:** The smaller the pipe diameter, the higher the lift.

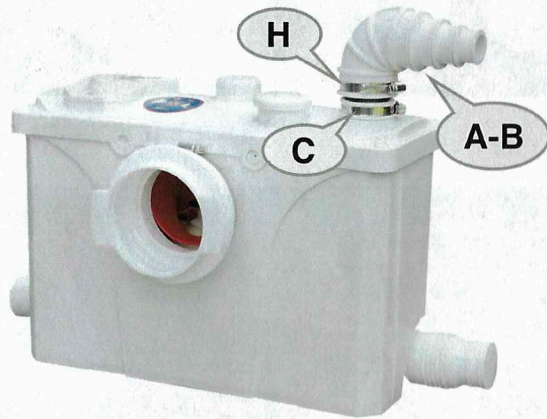

(5-3), In addition, at the corner of the PVC water pipe, be sure to use a large elbow composed of two 45-degree elbows, not a right-angle elbow, otherwise it will affect the vertical lifting height.

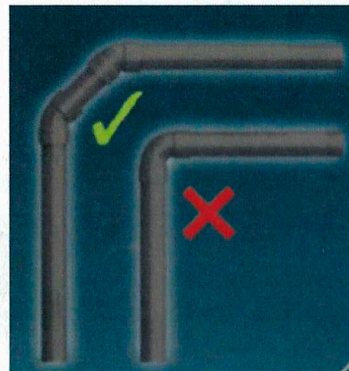
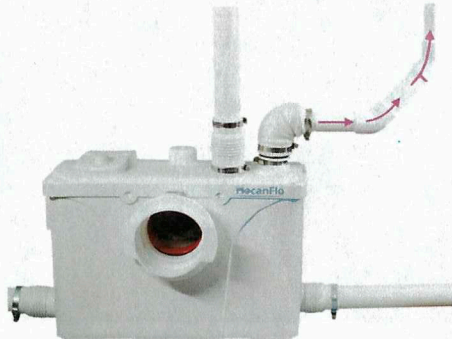

(5-4), Please install a ball valve (not provided) near the water outlet to prevent sewage leakage when the pump is disassembled.

(5-5), When connecting to the main pipe, the drain pipe must flow in from above the main pipe to prevent back-flow. As shown below.

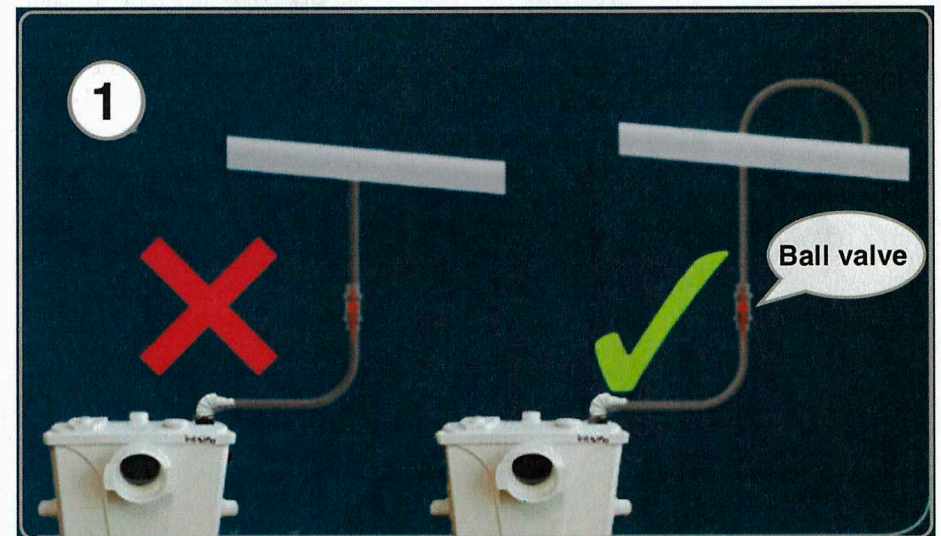

(5-6), For best performance, please drain upward first, and then drain the drain pipe to the main pipe at a 2%-3% incline, otherwise the sewage will flow back.

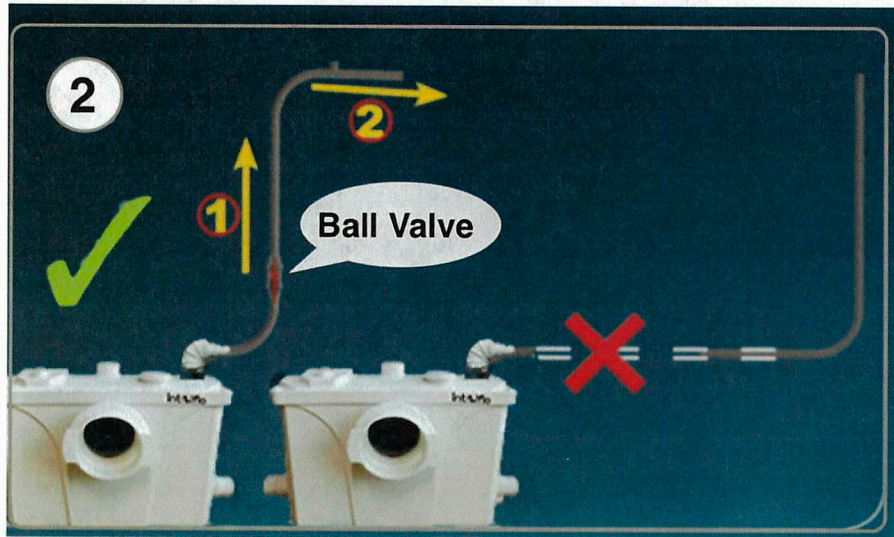

## 6. Installation of connecting pipe in shower room

(6-1), Install the plastic hose fitting (E) and lock it with the hose clamp (H). There are two inlet holes on the left and right sides of the sewage pump. They are used to connect the shower room and the sink. If the water inlet is not used, it can be plugged with accessory K.

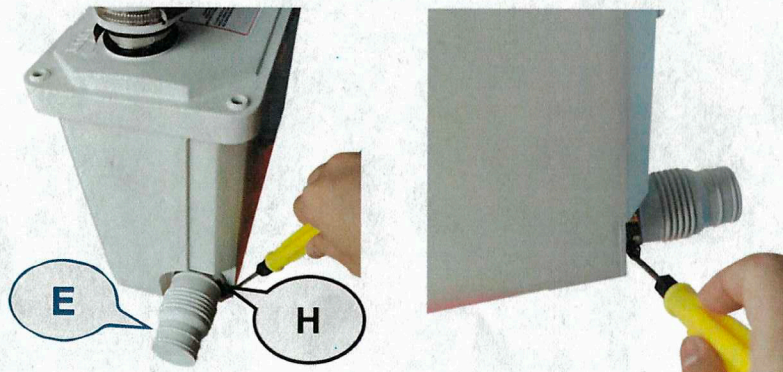

(6-2), When installing the shower room, first you can install a wooden or iron shower base, or build a cement platform. For waste water from the shower and bath, ensure that the slope of the siphon is at least 3% (0.4 inch per 40 inch), so that the waste water flows through the natural gravity to the unit position. If other sanitary units are connected to the disposal line along the disposal circuit, install check valves in the appropriate waste pipes to prevent back flow.

**Note:** Please make sure that the shower room chassis is raised to a minimum height of 6 inch (15 cm). It also depends on the distance between the shower room and the pump.

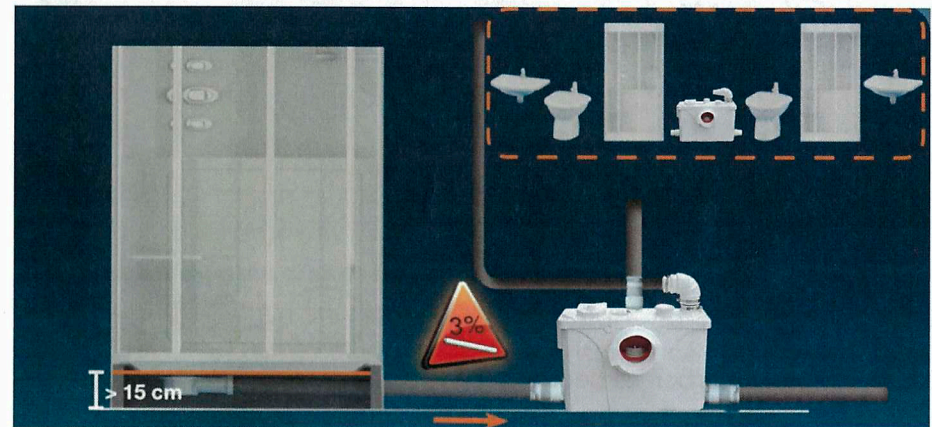

(6-3), If you need to connect more equipment and use the top water inlet, please open it with a saw and connect it with a hose.

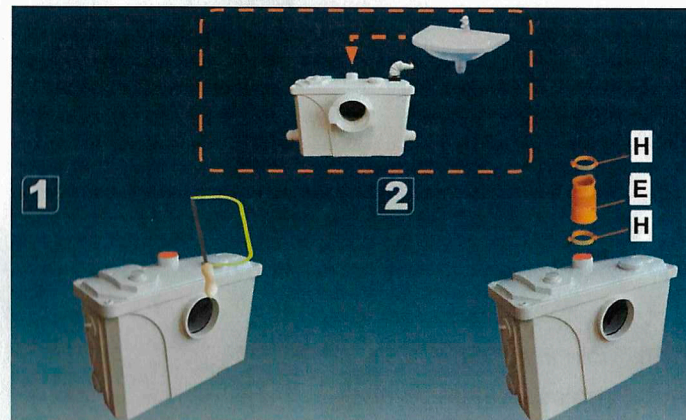

(6-4), If the toilet is not connected, you can use the lid (J) to block the toilet water inlet, and then use the clamp (G) to fix the toilet. Then only connect the sink, shower room and washing machine.

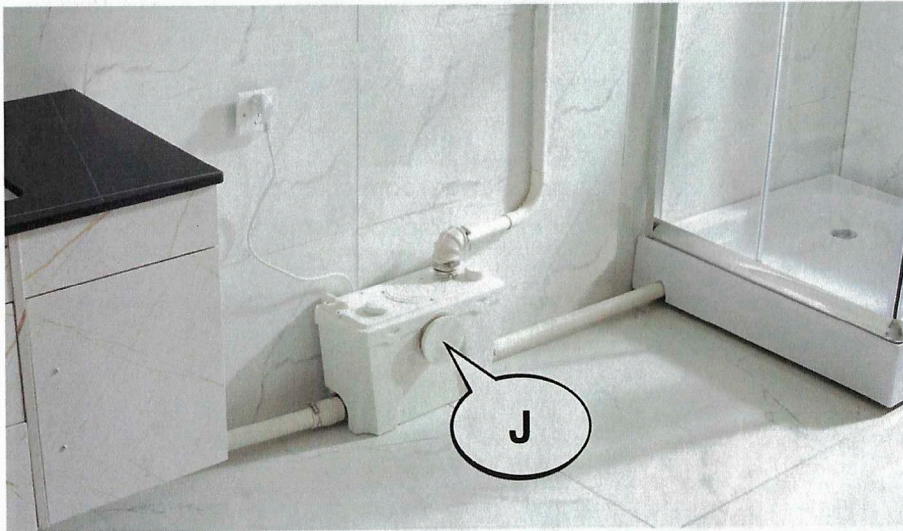

**7, Double deodorant function.**

One is activated carbon to deodorize, put a bag of activated carbon into the vent, and then cover it tightly

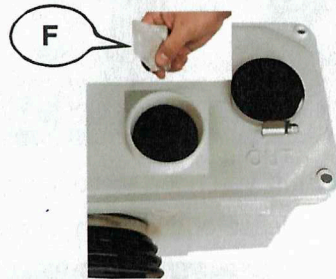

And the other is deodorization with ventilation ducts. See the picture on the right. The the size of vent pipe is 1-1/2" (40mm).

It is also possible to not install ventilation ducts, which will save a lot of trouble and cost. But activated carbon must be replaced once a year.

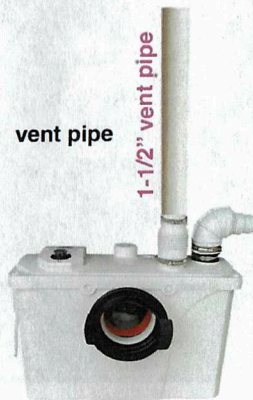

**8-1,** Finally connect the toilet and lock it with a 110-120mm hose clamp (G). The installation position of the macerating pump should be parallel to the toilet.



**8-2,** Do not discharge any acids, alkaloids, solvents painting, paint strippers, food waste, plastic bags, metal such as nails, hairpins, wood building materials, kitty litter or anything that could halt or damage or corrode the unit. Disregarding the above might damage the macerating unit and shall void your warranty.



**CAUTION** ⚠

**Do not** discharge any acids, alkaloids, solvents painting, paint strippers, food waste, plastic bags, metal such as nails, hairpins, wood building materials, kitty litter or anything that could halt or damage or corrode the unit. Disregarding the above might damage the macerating unit and shall void your warranty.

**9, Warnings:****(1) Electrical installation:**

- The connection shall be carried out by a qualified technician and the rules for electrical installations (NEN 1010) shall be met.
- If the power cord of the appliance is damaged, it shall be replaced by the manufacturer or supplier of the appliance. This will avoid creating dangers.
- The connection of your appliance is Class 1.

Connect the appliance to a socket with protective conductor connection.

**(2) Thermal protection:**

- This appliance is equipped with a thermal protection which switches off the power supply of the appliance after overheating for safety reasons. When the device returns to normal temperature, it will start automatically.
- Power on electrical connection only when the appliance is fully installed.
- In case of prolonged absence (e.g. vacation), the water supply to the appliance shall be closed.
- Do not expose the appliance to temperatures below 0°C or above 50°C.

**(3)** If the indications are not followed, it could cause personal security risks.

**(4) Wrong Use**

Use only for human excrement+soluble toilet paper. Equipment damage due to improper use is not covered by the warranty. Some examples of damage caused by improper use including grinding cotton wool, tampons, sanitary napkins, panty liners, food, condoms, towels hair and rinsing liquids and solvents or oils.

**10, Trouble shootings**

Some malfunctions of grinder are not practically serious. You can correct it by yourself. To diagnose and find a solution of the Trouble, refer to the diagram below. For other malfunctions, get contact the supplier or a qualified professional.

MALFUNCTIONS	POSSIBLE CAUSES	SOLUTIONS
The appliance starts occasionally to work	The connected pipelines are leaking	Check the installation in front of the appliance
	The check valve is leaking	Clean or replace the check valve
The motor is running properly, but the water runs slowly away.	The aerator in the lid is blocked	Clean the aerator
The engine is running properly, but non-stop or runs for a long time	The height or length of the drain is too large or too many bends are used (power failure)	Check the installation
	The pump is blocked	Turn off the power, disassemble the pump and unblock
The motor is not switched on	The power supply is not switched on	Switch on power supply (repeat)
	The plug is defective	Repair the plug
	Trouble with the motor or sensor	Remove the lid, flush clean, dry the sensor up (hair dryer)
The motor rattles with a noise	There's strange object in the motor	Remove the lid, clean it and remove the object
The motor is buzzing and not rotate	The condensator is broken or has a trouble with the motor	Get contact with a qualified specialist or the supplier
	There's a strange object in the motor	Remove the lid, clean it and remove the object